

Map Conference Rooms

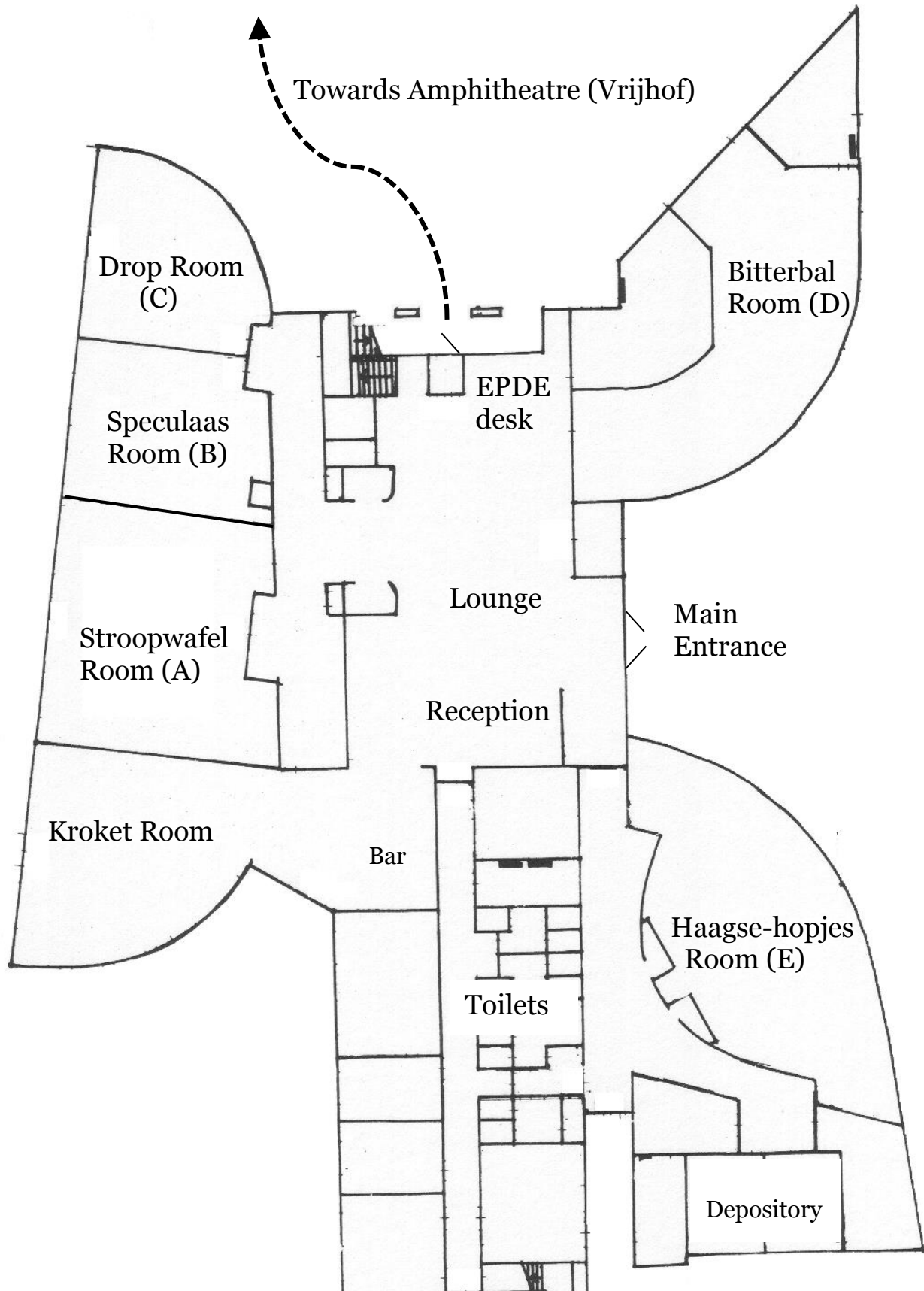

**Quick
update?**

Follow our Twitter hashtag **#EPDE2014**

Or

Make sure you install the **Conference4me** app on your smart phone

Campus Map

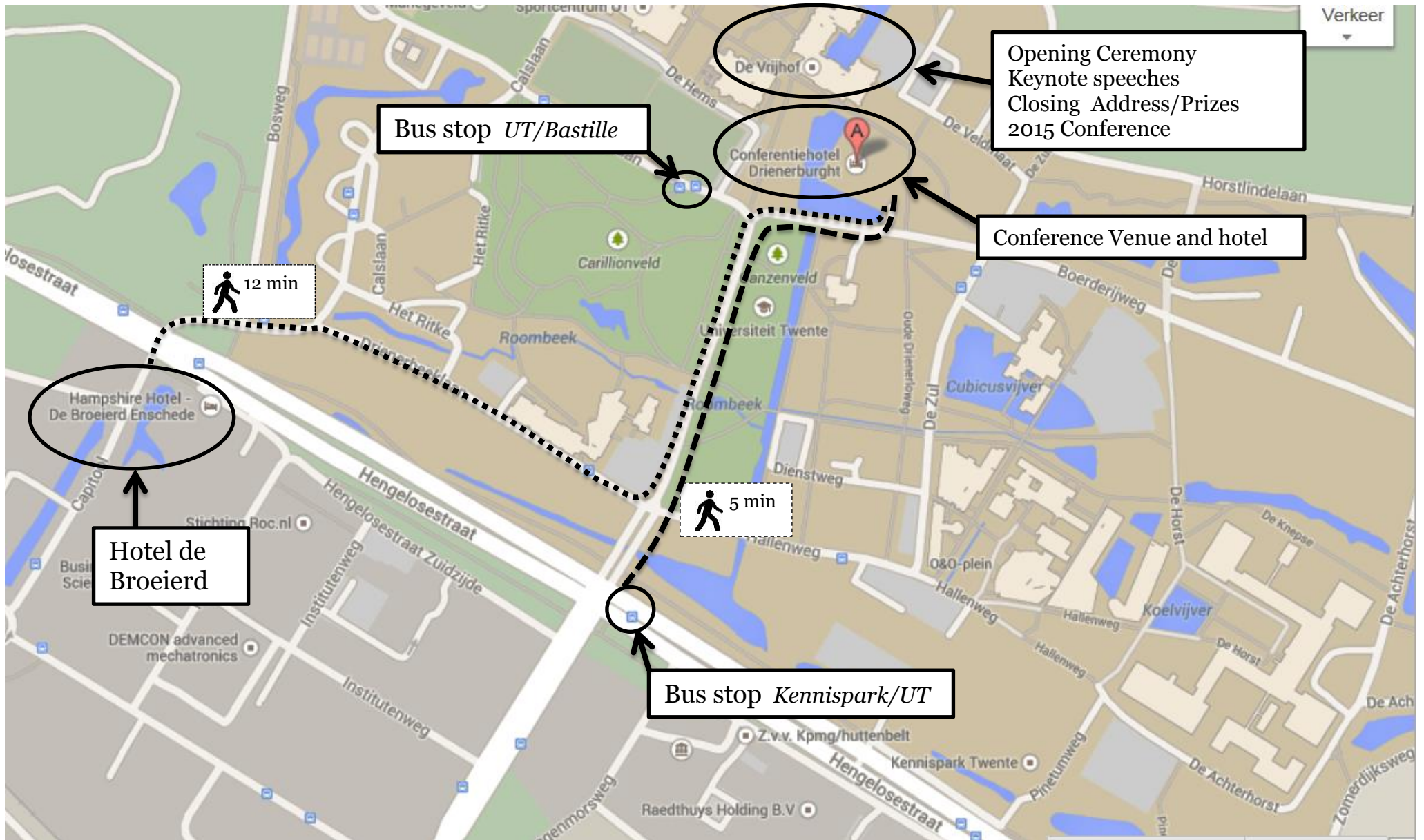

A detailed map of the campus and directions can be downloaded at <http://www.utwente.nl/download/campusmap.pdf>

Local Public Transportation

BUS From Train Station Enschede to University of Twente

Opt 1: Take Line 1 (*direction Universiteit Twente*) Stop at *UT/Bastille*

Opt 2: Take Line 9 (*direction Hengelo*) Stop at *Kennispark/UT*

BUS From University of Twente to Train Station Enschede

Opt 1: Take Line 1 (*direction Wesselerbrink*) at *UT/Bastille* stop at *Centraal Station*

Opt 2: Take Line 9 (*direction Enschede*) at *Kennispark/UT* stop at *Centraal Station*

BUS From Train Station Hengelo to University of Twente

Opt 1: Take Line 9 (*direction Enschede*) Stop at *Kennispark/UT*

Opt 2: Take stop train to Station Enschede Drienerlo

Take bus Line 1 (*direction Universiteit Twente*) and stop at *UT/Bastille*

BUS From University of Twente to Train Station Hengelo

Opt 1: Take Line 9 (*direction Hengelo*) Stop at *Kennispark/UT*

Opt 2: Take bus Line 1, stop at Station Enschede Drienerlo take train to Hengelo

TAXI

You can arrange a taxi by calling:

Taxi Maxx	053 4 500 5 00	06 48 51 52 11
Taxi Mondiaal	053 2 600 666	06 46 55 83 55

Traveling time between Enschede Train Station or Hengelo Train Station and the University of Twente is about 20 minutes

For transportation service to Schiphol Airport you can make reservations by sending an email with your traveling details to: info@mondiaal.nl

This company has agreed to offer reduced prices for groups of 6 – 8 people traveling all together to Schiphol Airport.